

OPERATING LIMITS

Capacities up to:	4 m³/h
Heads up to:	6 m
Max. working pressure:	10 bars
Temperature range:	-10°C to 110°C*
Max. ambient temperature:	+ 40°C

*up to 50% glycol by volume

NXL-NYL

DOMESTIC HEATING CIRCULATORS

Individual heating, air-conditioning 50 Hz

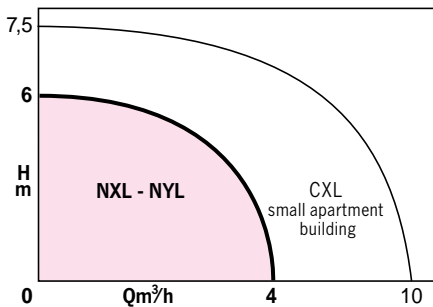

APPLICATIONS

Accelerated hot- or cold-water circulation in open or closed heating or air-conditioning circuits:

- Detached houses;

- Greenhouses, etc
New installations, old (renovations), extensions.



NXL 13-32P :
circulator diameter allowing direct connection to 1 1/4" pipe



NYL 33-25P :
130 mm between flanges, terminal box at 9 o'clock for easier access to unions



Inside of new terminal box:
easier electrical connection and speed selection



NXL 13-25P

Two motor sizes precisely dimensioned for the required power:

NXL 53-32P

NXL-NYL

ADVANTAGES

- **Quiet:** curves appropriate for floor-mounted boilers, flow limited to reduce flowing-water noise.
- **Reliable:** motor protected from impurities by bronze filter. High starting torque.
- **Optimized efficiencies:** energy savings up to 20%.
- **No sealing problem:** Direct connection, without adapter rings, to 1" or 1 1/4" pipes.

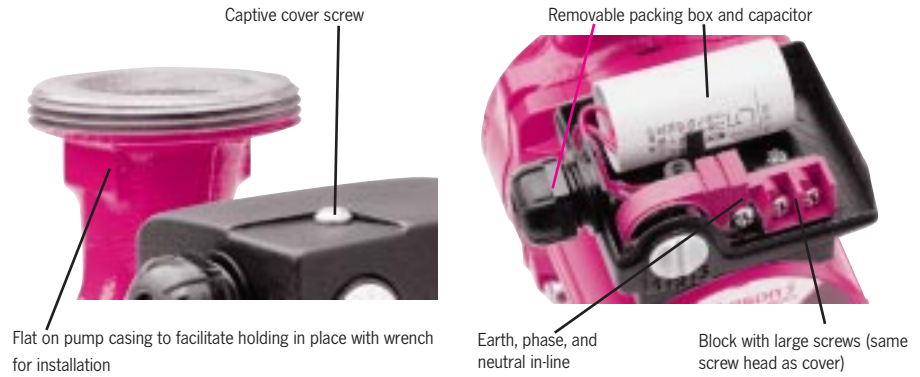

Flat on pump casing to facilitate holding in place with wrench for installation

Block with large screws (same screw head as cover)

DESIGN

• **Pump**
Pump casing with threaded ports for direct mounting on pipe. Rotating parts in contact with water made of corrosion-proof materials. Stainless-steel impeller neck ring.

• **Motors**
Three speeds with manual selection. Wet rotor, bearings lubricated by pumped liquid. Rotor chamber protected by sintered bronze filter. Manual bleed when started up.

Speed	: see table
Power supply	: single-phase, 230 V
Frequency	: 50 Hz : (60 Hz optional)
Insulation class	: F (155°C)
Temperature class	: TF110
Protection index	: IP 42
Conformity	: NF EN 60.335.1 and 2.51
Type approvals	: CE : VDE · IMQ

MAX. SPEED SELECTION CHART

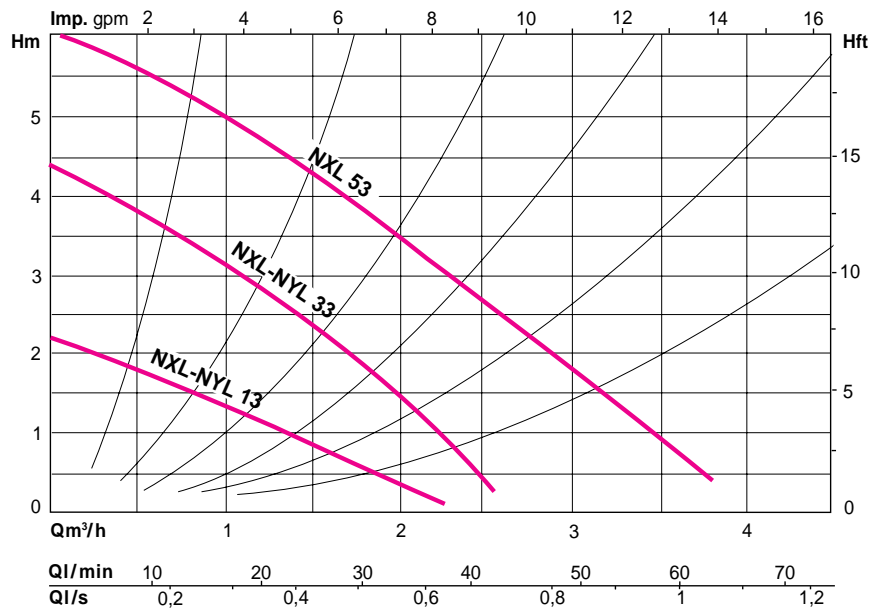

STANDARD CONSTRUCTION

Main part	Material
Pump housing.....	Cast iron GG20
Impeller	Composite mat.
Shaft.....	St. steel X40 Cr13
Impeller neck ring	Stainless steel
Bearings	Graphite
Seals.....	Ethy.-Propylene
Motor housing	Aluminium

MINIMUM SUCTION PRESSURES ACCORDING TO OPERATING TEMPERATURE

Type	82°C	95°C	110°C
All models	1.5 m w.g	3 m w.g	10 m w.g

10.2 m w.g. = 1 bar

To avoid bearing damage and the risks of cavitation of the pump, it is essential to observe the minimum pressures stated above.

PUMP IDENTIFICATION

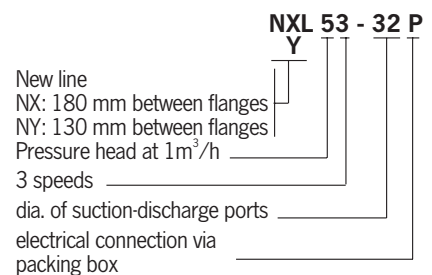

HYDRAULIC PERFORMANCE

3 SPEEDS

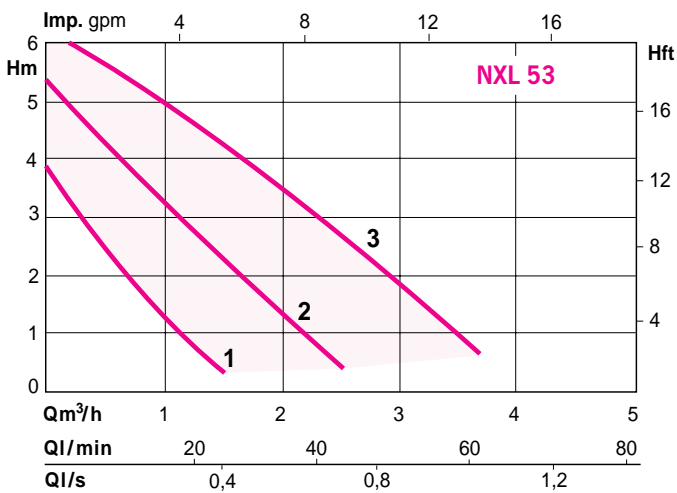
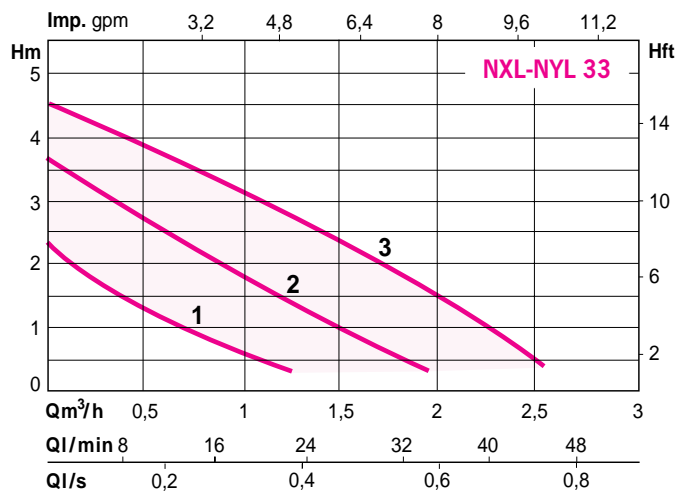
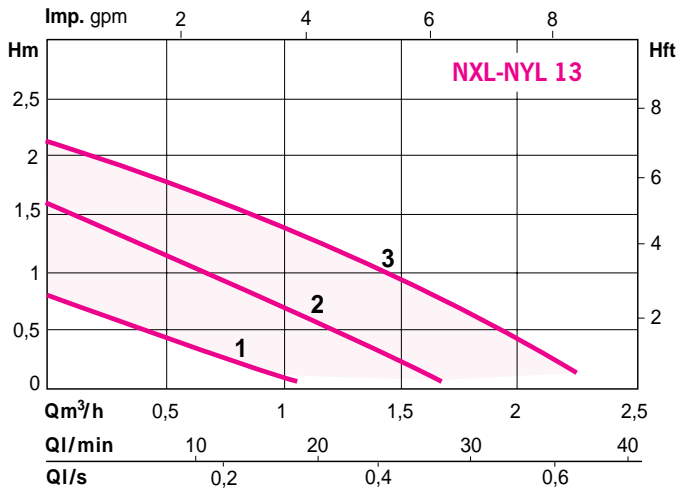

INSTALLATION POSITIONS

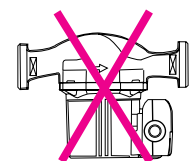
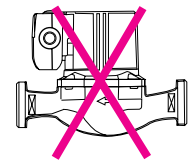
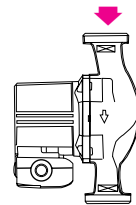
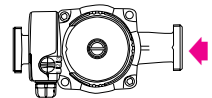
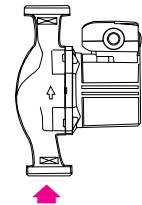

ELECTRICAL DATA AND DIMENSIONS

NXL 13
NXL 33

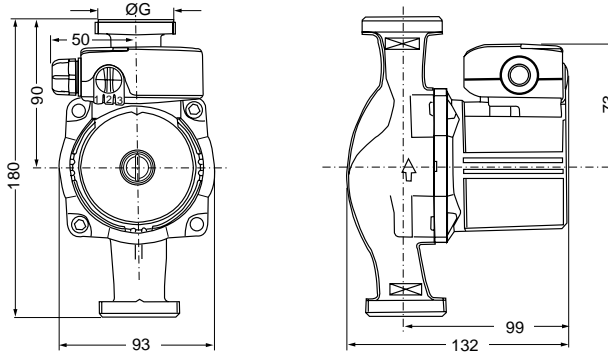

NXL 53

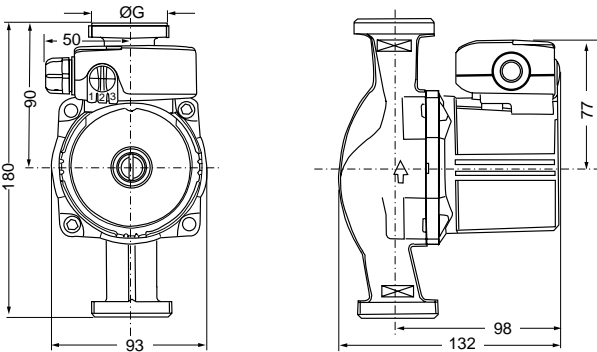

NYL 13
NYL 33

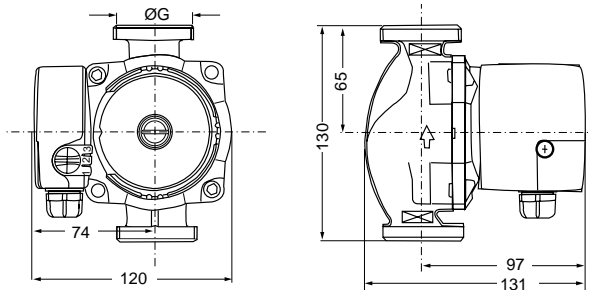

FEATURES

a) Electrical

- All types single-phase, 230-V, 50-Hz, with capacitor built into terminal box.
- Motor protection circuit-breaker not required.

b) Installation

- Motor shaft always horizontal.
- Connection to installation:

- by unions

c) Packaging

- Supplied with gaskets, without unions.

d) Maintenance

- Standard exchange of circulator.

RECOMMENDED OPTIONS AND ACCESSORIES

- Unions.
- Isolating valves.
- Unsticking plug; facilitates unsticking of shaft and rotor (without removing plug).

ORDER REFERENCE	P2 W	capacitance- µF x V	M O T O R			P1 (W)	Current- (A)	P O M P E		CAN BE CONNECTED TO THREADED PIPE				
			speed selector setting	speed (rpm)	mass (kg)			Dia G	Ø 3/4"	Ø 1"	Ø 1 1/4"			
NXL 13-25 P	10	1,6 x 400	1	1000	18	0,09	1 1/2"	2,35	RED 2027	RU 2634	—			
NXL 13-32 P			2	1450	31	0,15	2"					—	RED 2634	RU 3342
			3	1850	48	0,21								
NXL 33-25 P	20	2 x 400	1	1000	30	0,13	1 1/2"	2,35	RED 2027	RU 2634	—			
NXL 33-32 P			2	1400	46	0,20	2"					—	RED 2634	RU 3342
			3	1900	65	0,28								
NXL 53-32 P	40	2,6 x 400	1	950	46	0,20	2"	2,6	—	RED 2634	RU 3342			
			2	1300	67	0,30								
			3	1850	93	0,40								
NYL 13-25 P	10	1,6 x 400	1	1000	18	0,09	1 1/2"	2,35	RED 2027	RU 2634	—			
			2	1450	31	0,15								
			3	1850	48	0,21								
NYL 33-25 P	20	2 x 400	1	1000	30	0,13	1 1/2"	2,35	RED 2027	RU 2634	—			
			2	1400	46	0,20								
			3	1900	65	0,28								